

**CX**

**Spare Parts Catalogue**  
**Catalogue de Pièces de Rechange**  
**Ersatzteilkatalog**  
**Onderdelencatalogus**



Contents	page	Sommaire	page
Extended hood	3	Sas	3
Autotimer + side panels	4	Autominuteur + panneaux latérales	4
Module 600 mm	5	Module 600 mm	5
Module 900 mm	6	Module 900 mm	6
Pump	7	Pompe	7
Wash systems	8	Rampe de lavage	8
Side wash	9	Rampe de lavage latérale	9
Drain	10	Vidange	10
Tank heating + floatswitch	11	Chauffage du bac + interrupteur à flotteur	11
Tank heating – hot water / steam	12	Chauffage du bac – eau surchauffée / vapeur	12
Rinse section	13	Zone de rinçage	13
Rinse system	14	Rampe de rinçage	14
Dual rinse pump	15	Pompe de double-rinçage	15
Pipework	16	Tuyauterie	16
Fill piping	17	Remplissage	17
Rinse booster heater electric	18	Chaudière électrique	18
Rinse booster heater 0,5 m <sup>2</sup> steam / hot water	19	Chaudière 0,5 m <sup>2</sup> eau surchauffée / vapeur	19
Rinse booster heater 0,9 m <sup>2</sup> steam / hot water	20	Chaudière 0,9 m <sup>2</sup> eau surchauffée / vapeur	20
Vent hood	21	Capot d'extraction	21
Exhaust extraction-fan	22	Extraction des buées – ventilateur	22
Condenser housing	23	Condenseur habillage	23
Condensers	24	Condenseurs	24
Drive unit	25	Entraînement	25
Conveyor + tracks	26	Berceau + rails	26
Drier section	27	Zone de séchage	27
Blower electric	28	Soufflage électrique	28
Blower steam + hot water	29	Soufflage vapeur + eau surchauffée	29

Inhalt	Seite	Inhoud:	zijde
Vorhaube	3	Kap	3
Autotimer + Seitenverkleidungen	4	Autotimer + zijdelingse bekleidingen	4
Modul 600 mm	5	Modul 600 mm	5
Modul 900 mm	6	Modul 900 mm	6
Pumpe	7	Pomp	7
Waschsysteme	8	Was systeem	8
Seitliche Waschung	9	Zijdelingse wasarmen	9
Ablauf	10	Afvoer	10
Tankheizung + Schwimmerschalter	11	Tankverwarming + zwem – schakelaar	11
Tankheizung – Heißwasser / Dampf	12	Tankverwarming – heet water / stoom	12
Klarspülzone	13	Naspoelzone	13
Spülsystem	14	Naspoeling	14
Duo-Spülpumpe	15	Duo-naspoeling	15
Rohrleitungen	16	Buisleidingen	16
Fülleitung	17	Vulling	17
Durchlauferhitzer elektrisch	18	Booster elektrisch	18
Durchlauferhitzer 0,5 m <sup>2</sup> Heißwasser/Dampf	19	Booster 0,5 m <sup>2</sup> stoom / heet water	19
Durchlauferhitzer 0,9 m <sup>2</sup> Heißwasser/Dampf	20	Booster 0,9 m <sup>2</sup> stoom / heet water	20
Absaughaube	21	Wasem afzuiging – kap	21
Wrasenabzug – Ventilator	22	Wasem afzuiging – ventilator	22
Kondensator – Gehäuse	23	Kondensor bekleiding	23
Kondensatoren	24	Kondensors	24
Antrieb	25	Aandrijving	25
Schwingrahmen + Laufschiene	26	Zwaai Raam + spoorweg	26
Trockenzone	27	Droogzone	27
Trocknungsgebläse elektrisch	28	Ventilator van droger elektrisch	28
Trocknungsgebläse, Dampf + Heißwasser	29	Ventilator van droger – heet water + stoom	29

L – R = Links – Rechts  
left – right  
gauche – droite

R – L = Rechts – Links  
right – left  
droite – gauche

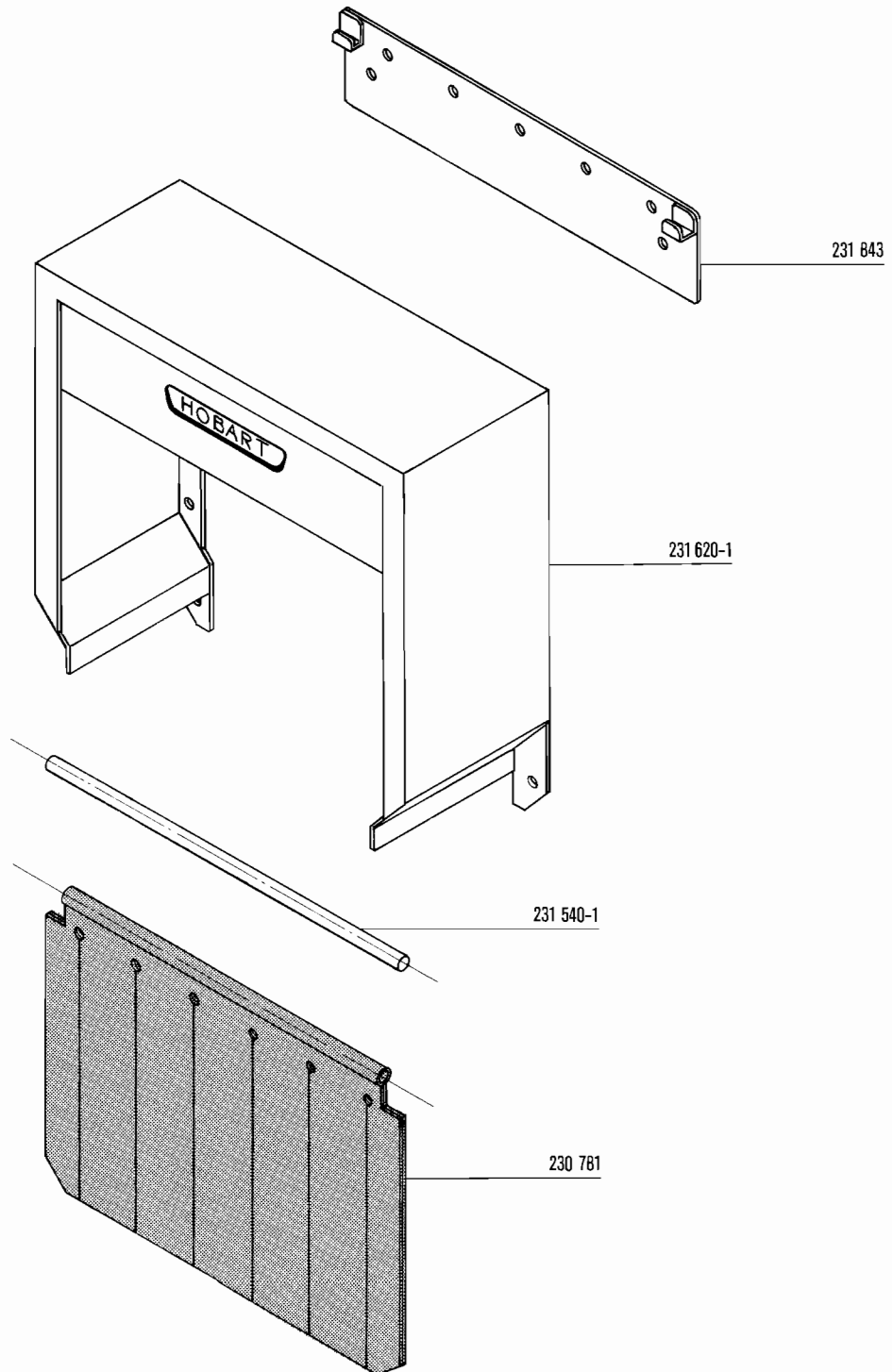
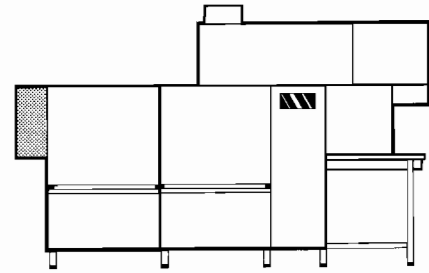

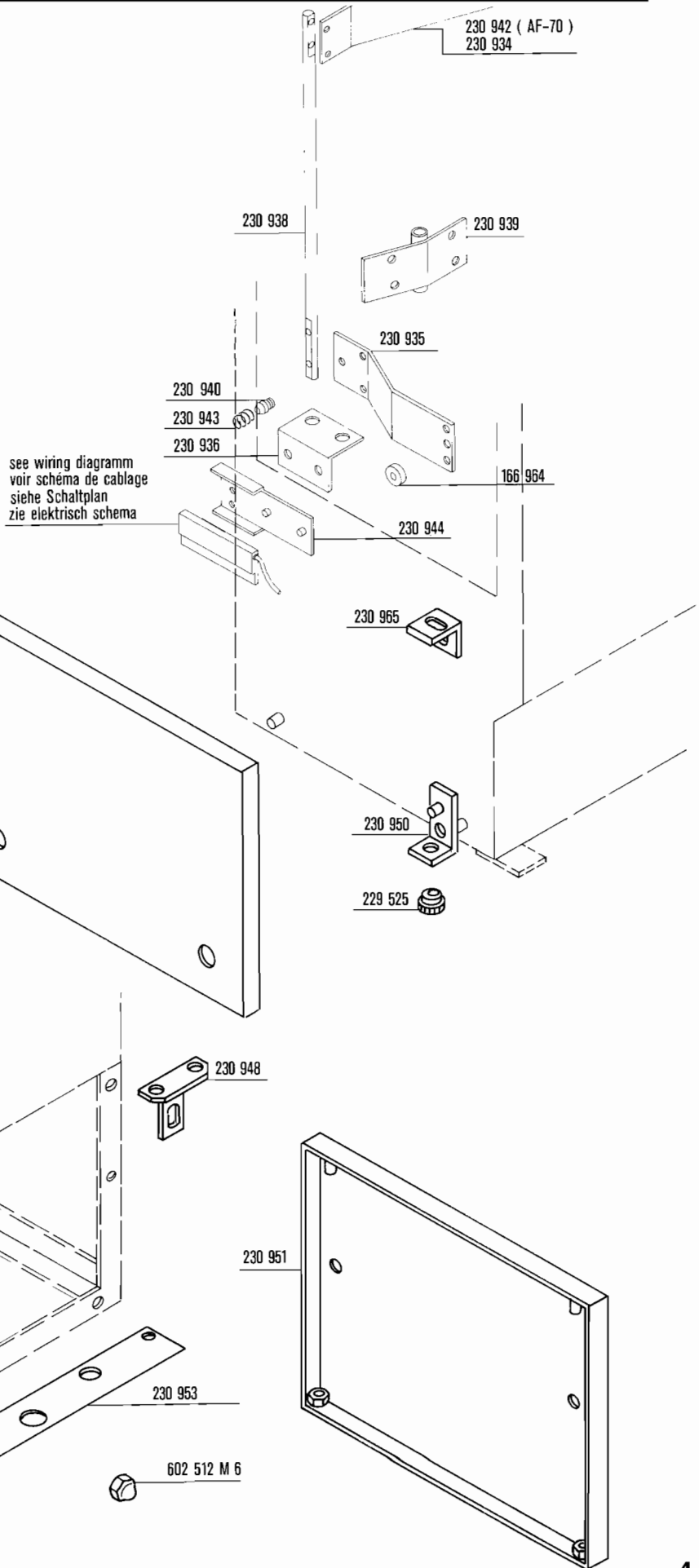
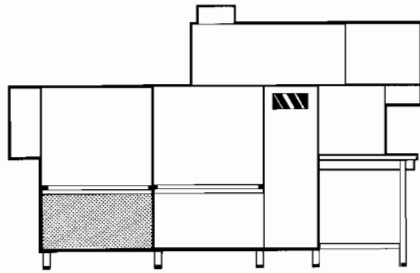

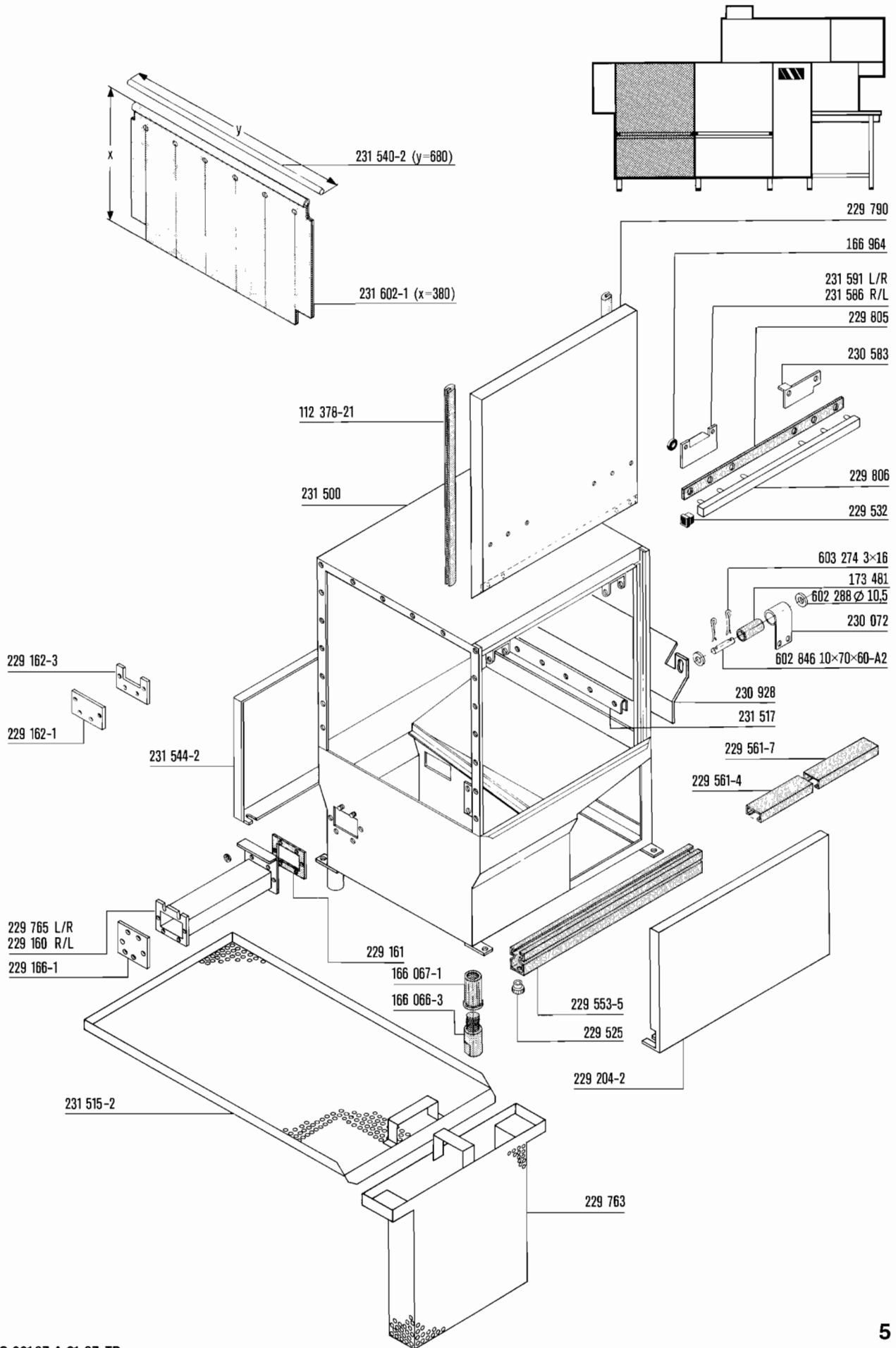

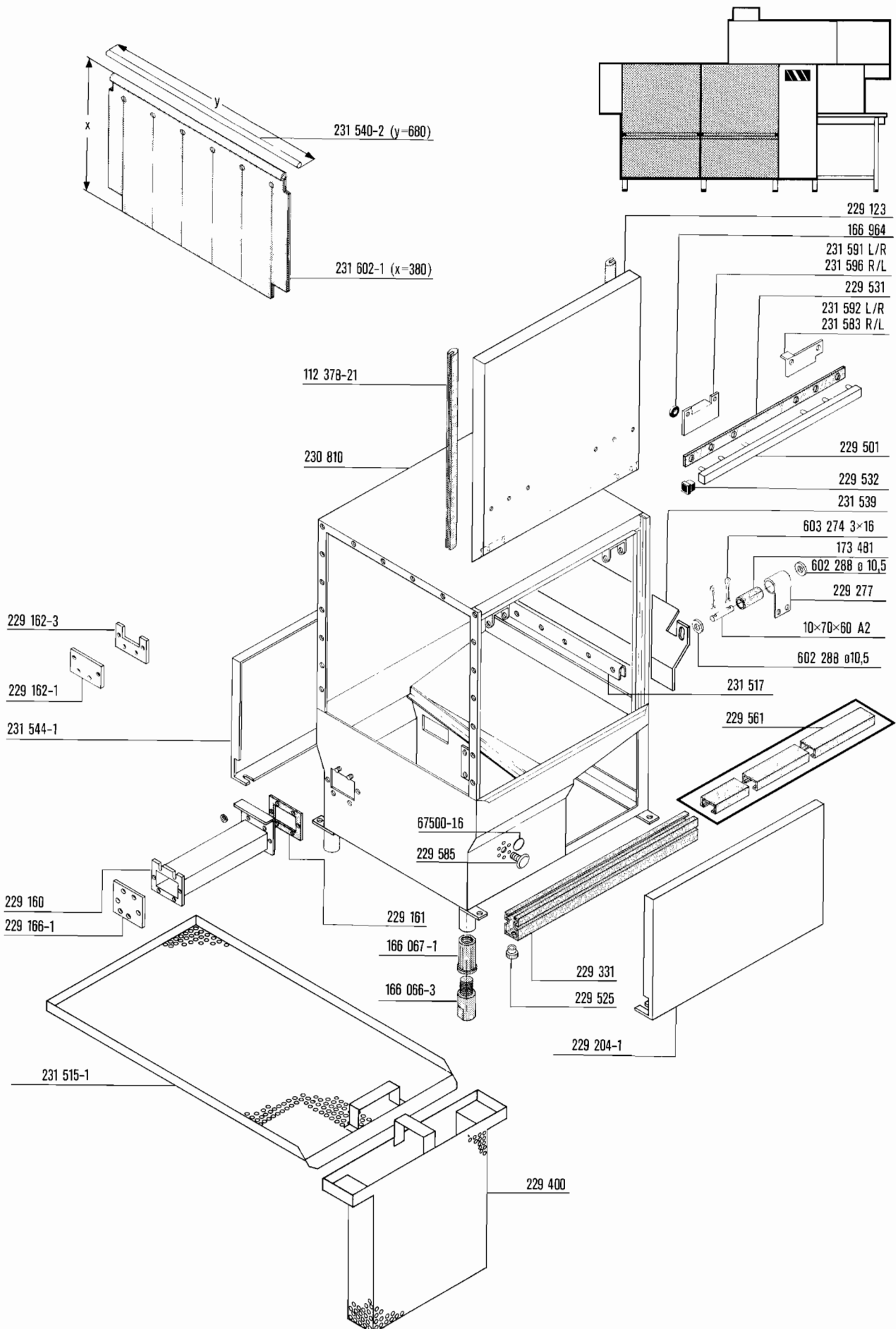

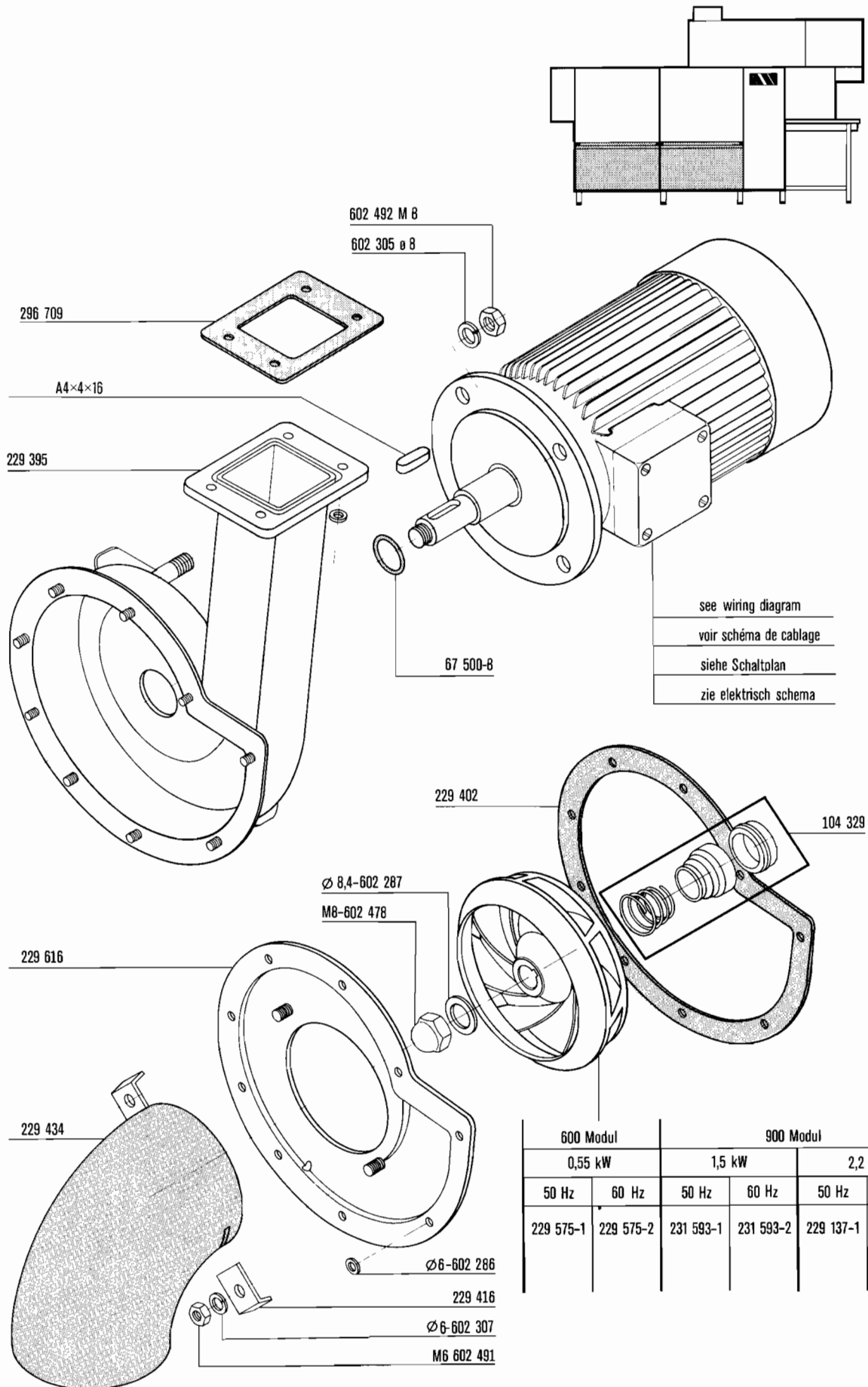

600 Modul		900 Modul			
0,55 kW		1,5 kW		2,2 kW	
50 Hz	60 Hz	50 Hz	60 Hz	50 Hz	60 Hz
229 575-1	229 575-2	231 593-1	231 593-2	229 137-1	229 137-2

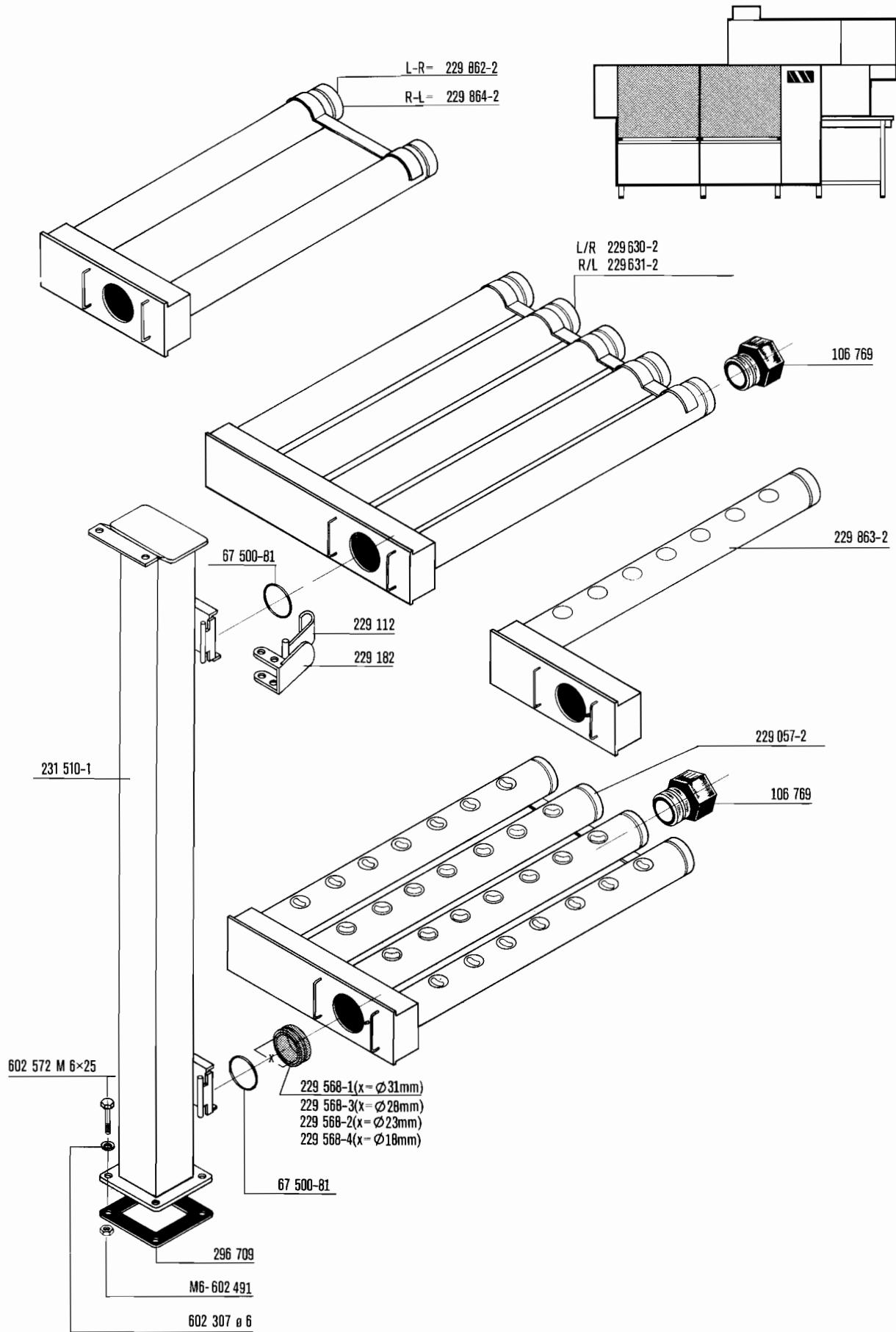



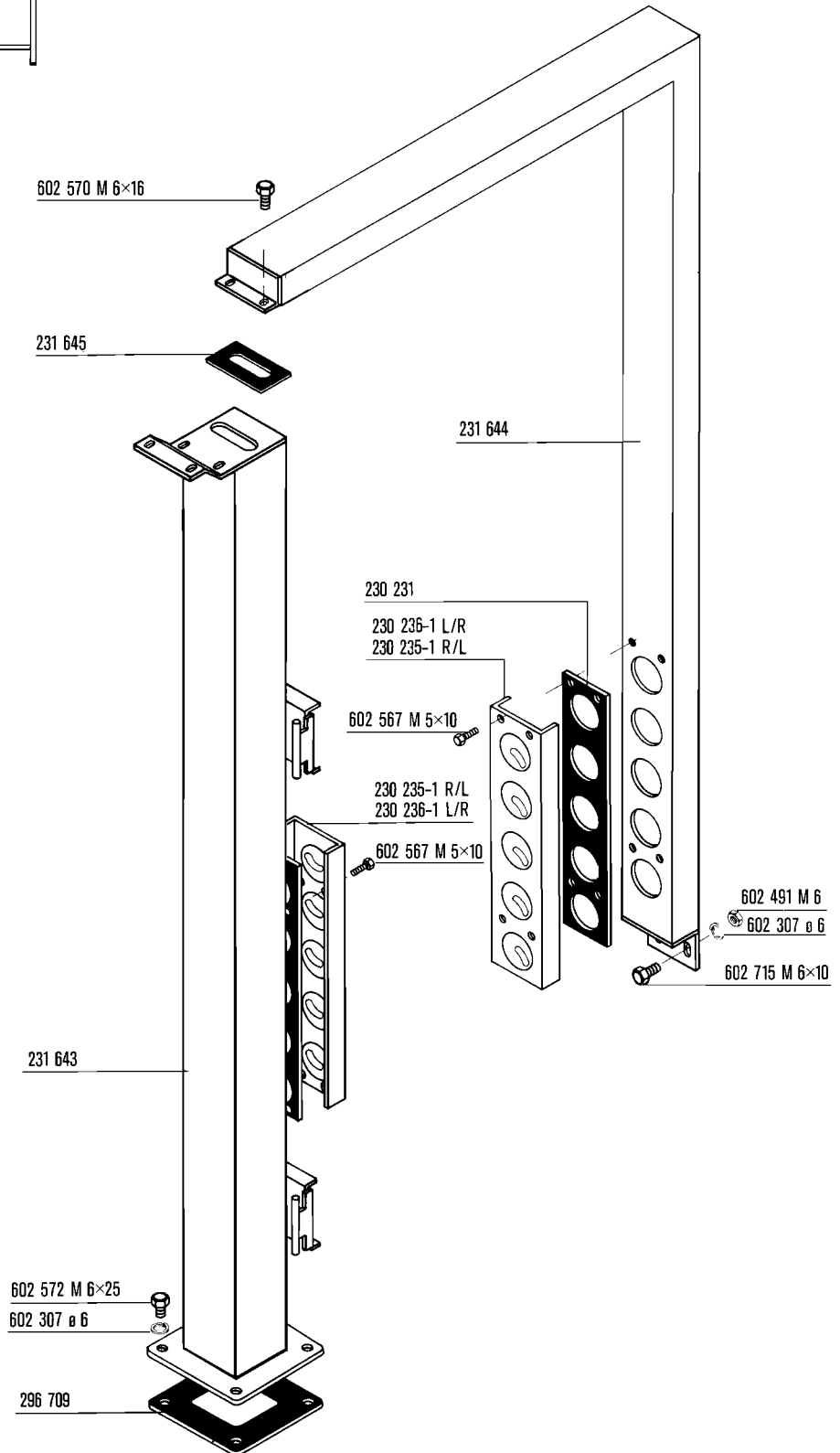
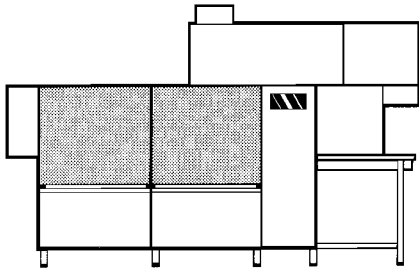

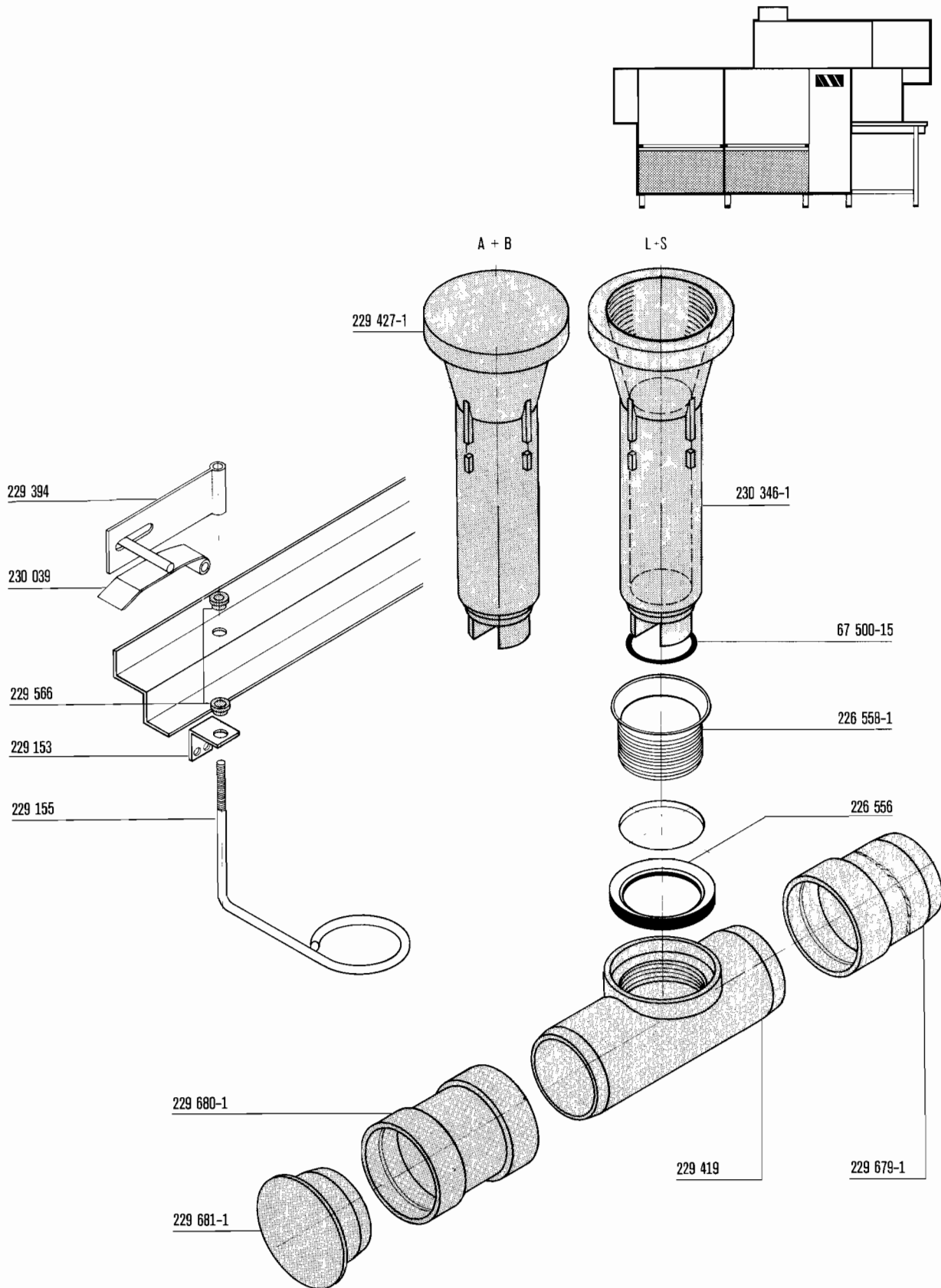

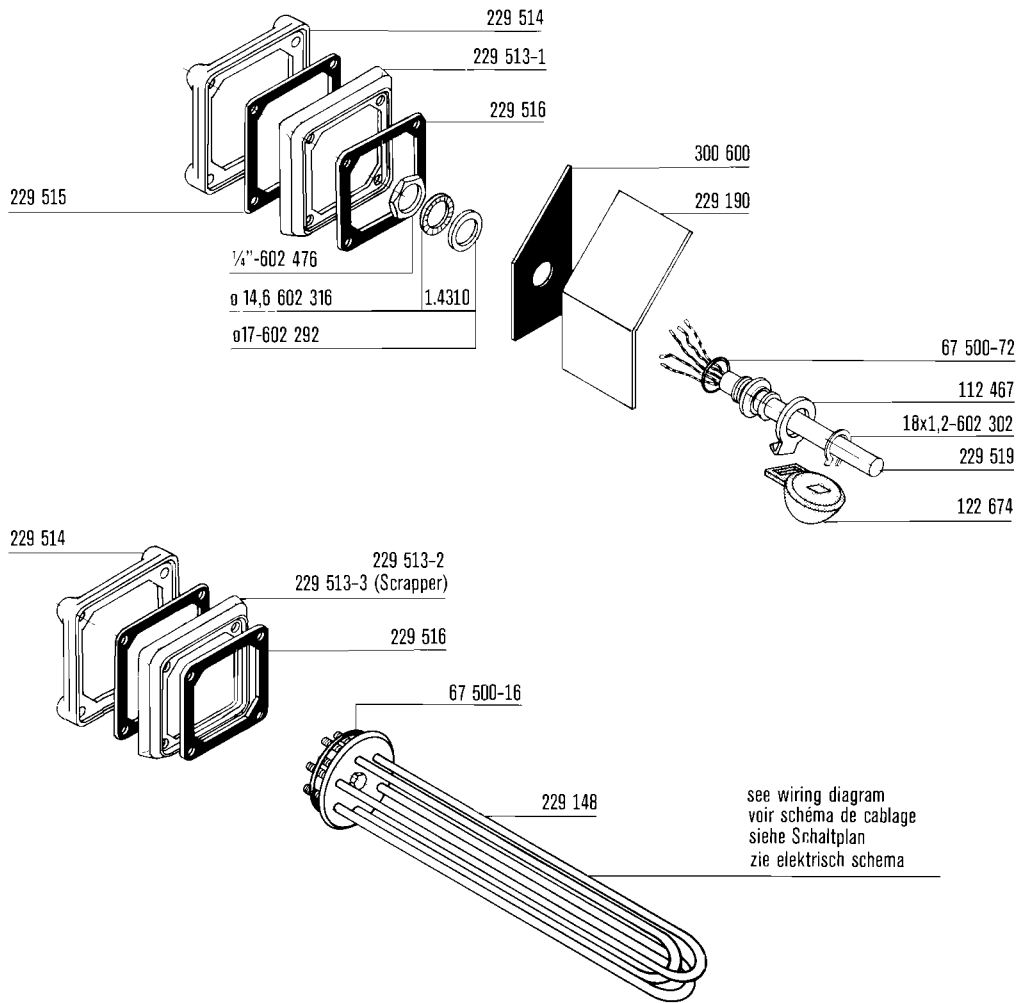
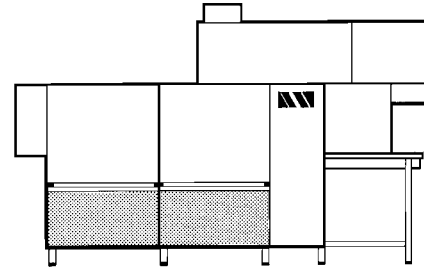

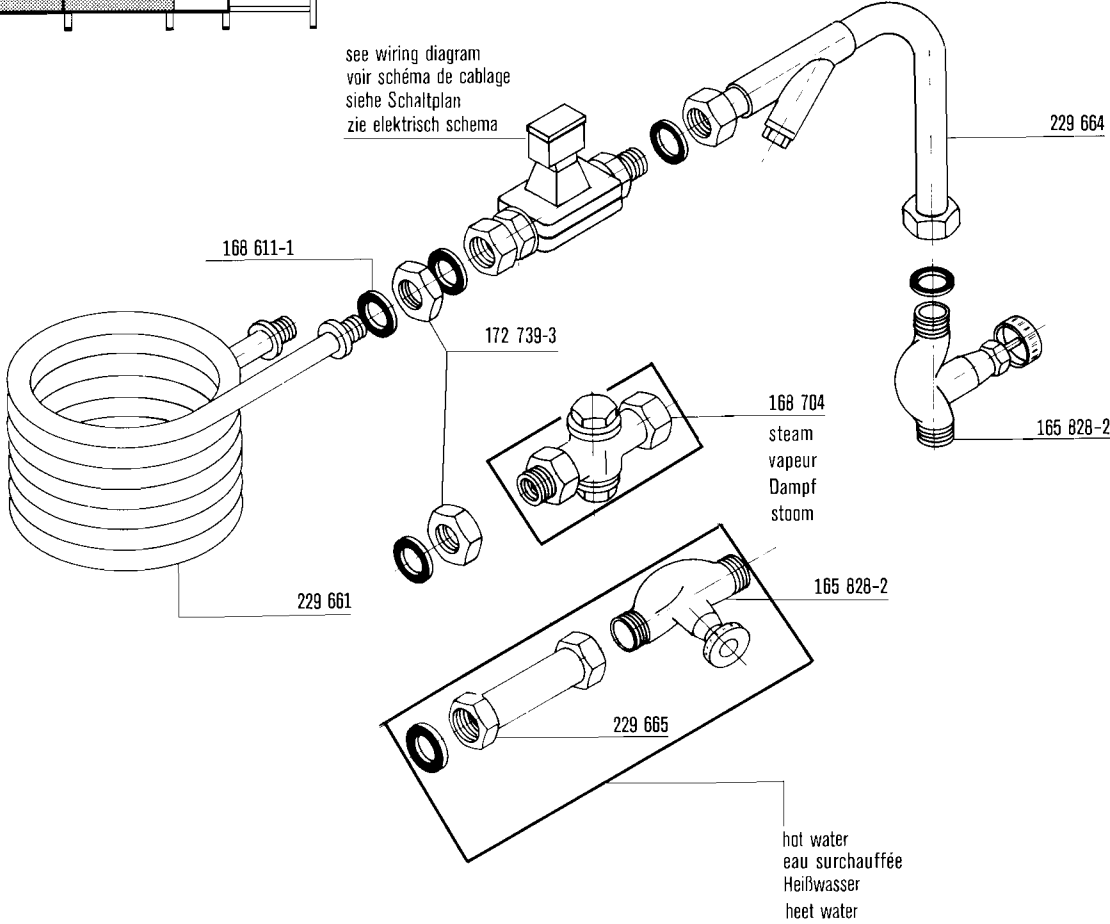
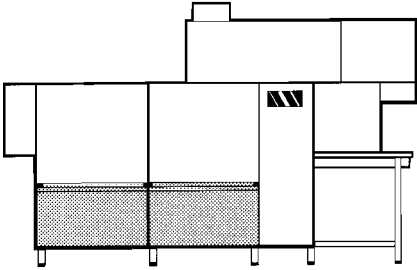

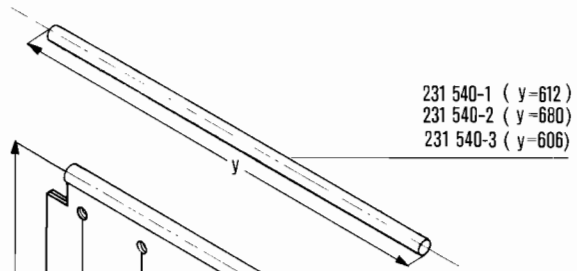
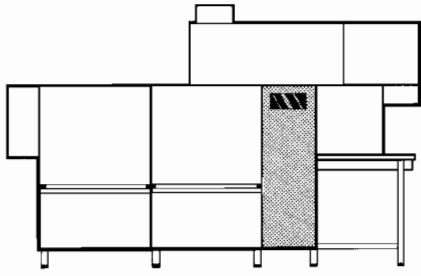

231 540-1 ( y=612 )  
 231 540-2 ( y=680 )  
 231 540-3 ( y=606 )

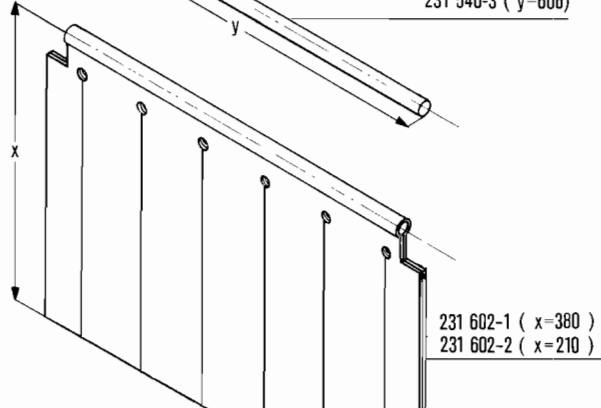

231 602-1 ( x=380 )  
 231 602-2 ( x=210 )

order number printed on part  
 numéro imprimé sur pièce  
 Nr. siehe Aufdruck  
 nummer afgedrukt

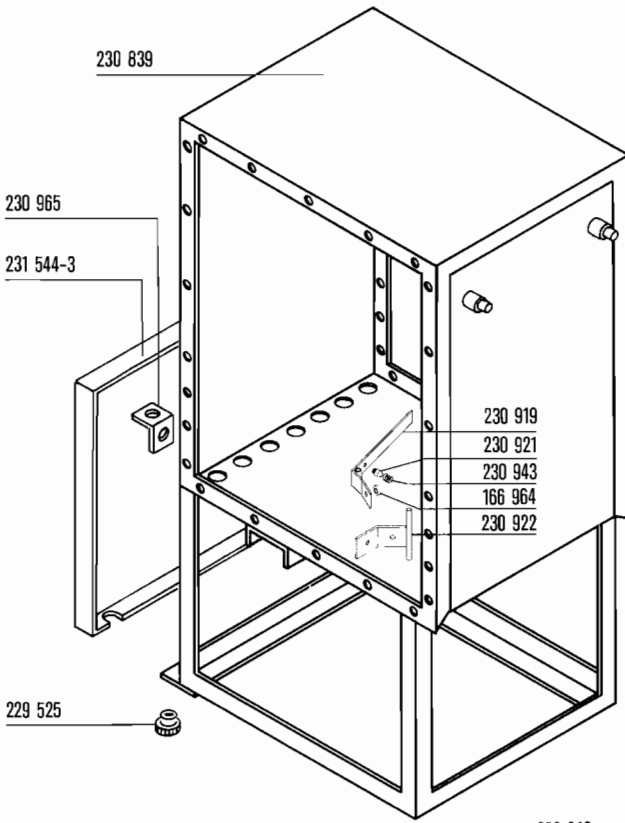

230 839

230 965

231 544-3

229 525

230 919  
 230 921  
 230 943  
 166 964  
 230 922

229 157-3\*\*  
 229 157-2\*

229 167-1 (220-260 V )

229 048

229 169 (4 m)

230 733

230 842

230 946

229 518-2

230 244

229 177

166 067-1

166 066-3

230 926

231 753

\*\* yellow, jaune, gelb, geel  
 \* green, vert, grün, groen

see wiring diagram  
 voir schéma de cablage  
 siehe Schaltplan  
 zie elektrisch schema

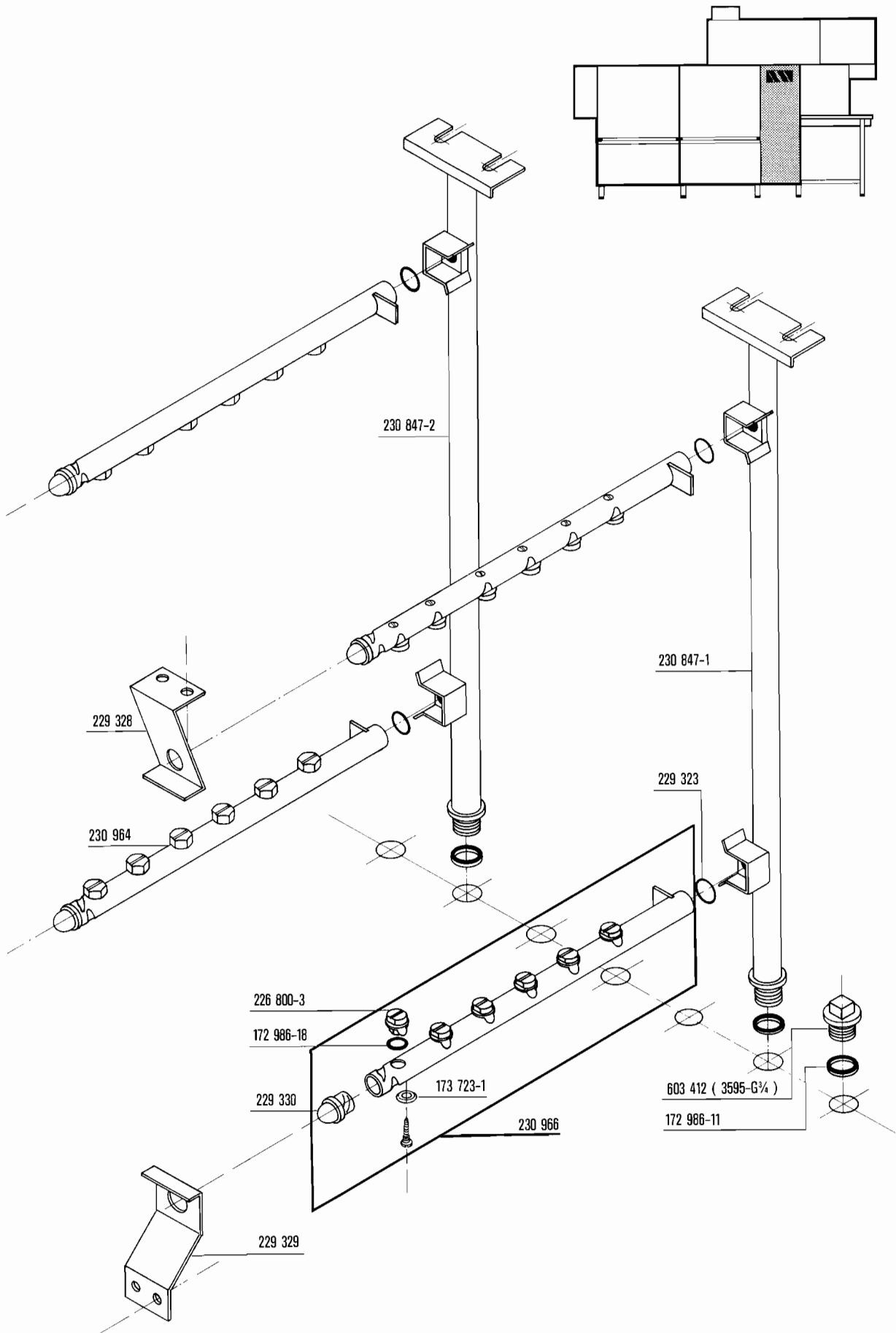

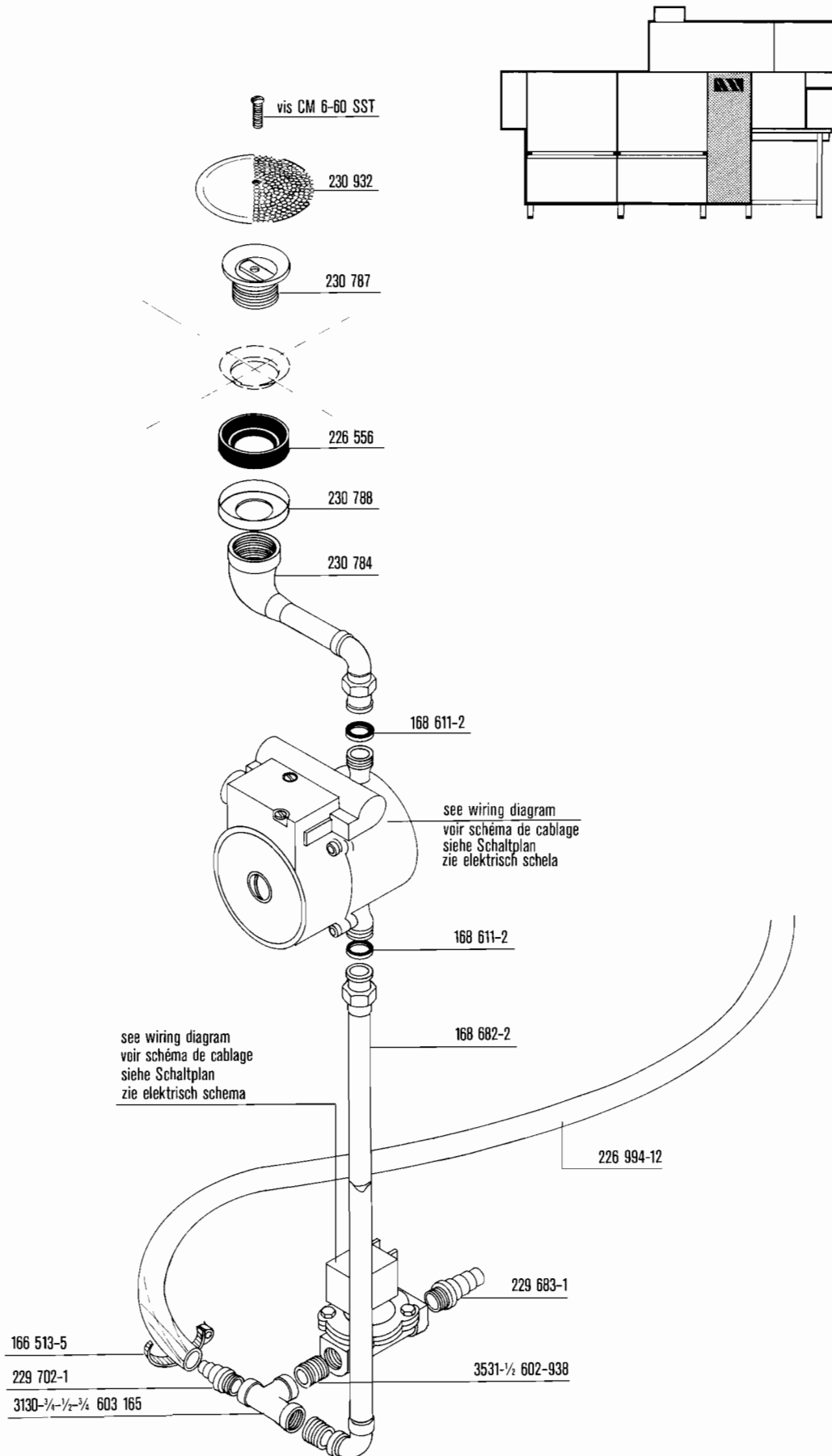

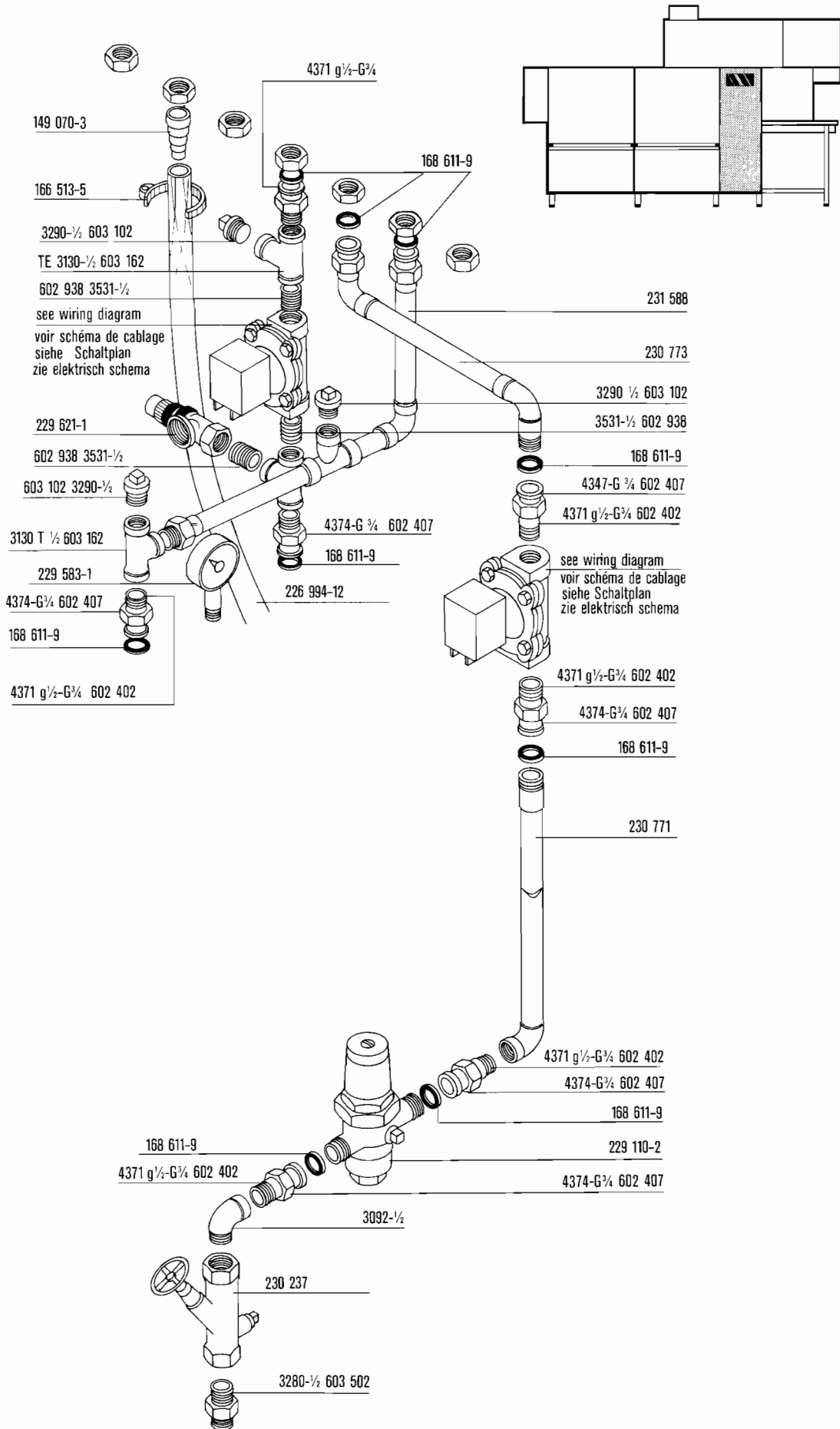



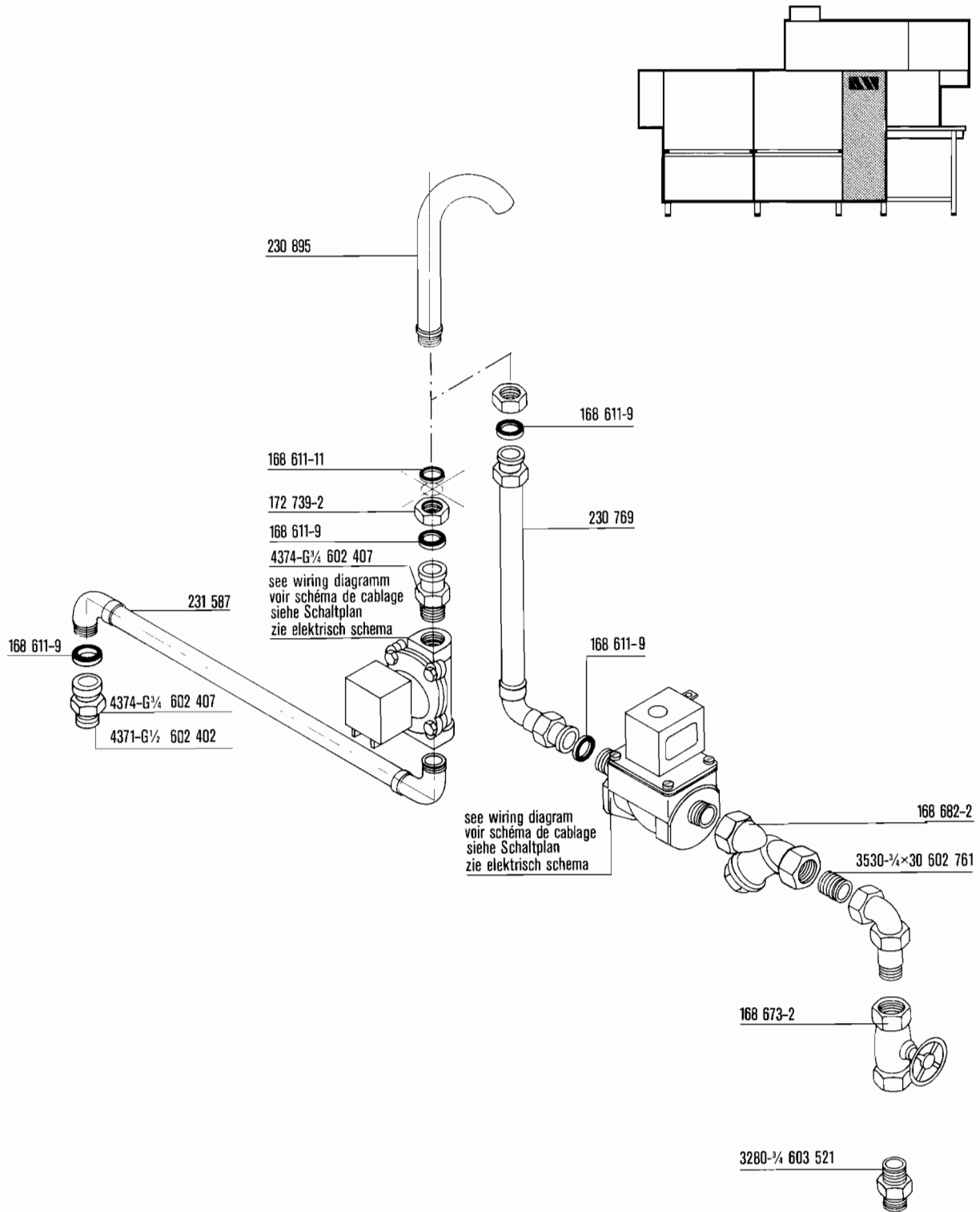

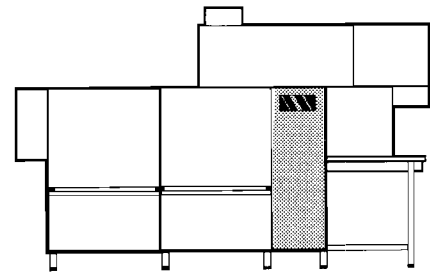

UK

- 230 036
- 230 035
- 137 146

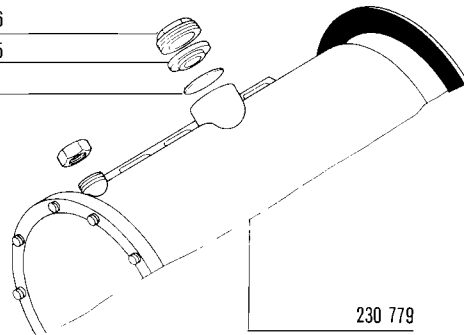

230 779

229 583-1



169 139-3

231 578

- 229 148-1 220 V 18 kW-2x
- 229 148-2 240 V 27 kW-3x
- 229 148-5 254 V 36 kW-4x

67 500-16

602 305

602 492

229 491

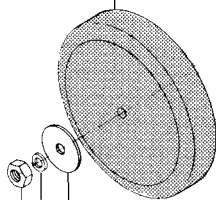

228 694-4

602 307

602 491

- 300 692-1 ( 18 kW )
- 300 692-2 ( 27 kW )
- 300 692-3 ( 36 kW )

230 994

3599 c-3/4  
602 794

230 873

229 489

230 869

231 577

